

CUBE2, CUBE4 RECESSED SPACKLE FLANGE INSTALLATION INSTRUCTIONS

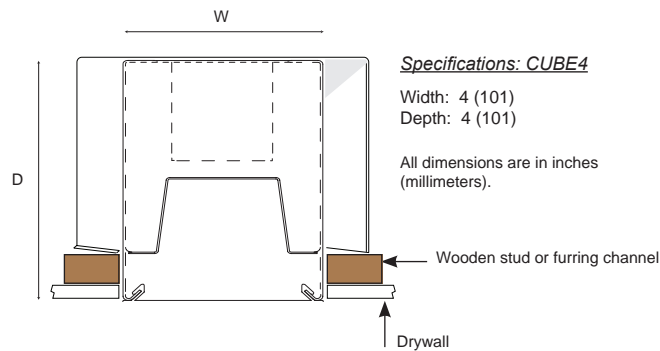

• PART LIST

- | | |
|-----------------------|-------------------------|
| A: LED module plate | D: Access plate |
| B: Lens | E: Safety bracket screw |
| C: BX cable connector | F: Safety bracket |

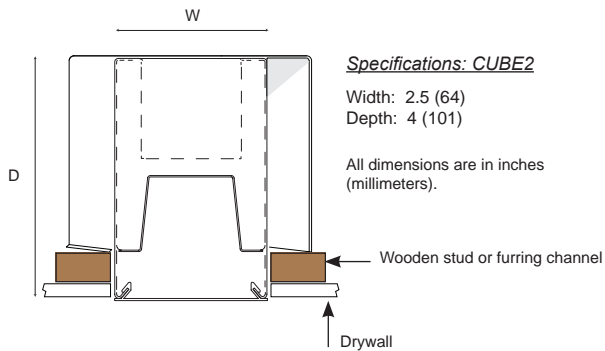
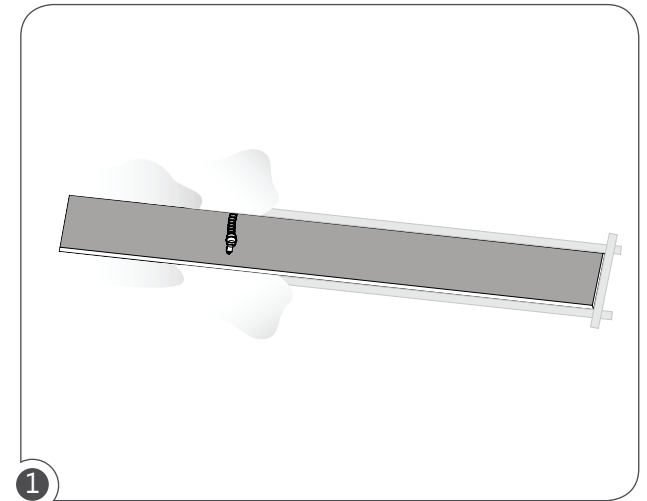

Make an opening on Drywall according to the dimensions.
CUBE2 (4ft) : 48-3/16" x 2-5/8", (8ft) : 96-3/16" x 2-5/8"
CUBE4 (4ft) : 48-3/16" x 4-1/8", (8ft) : 96-3/16" x 4-1/8"

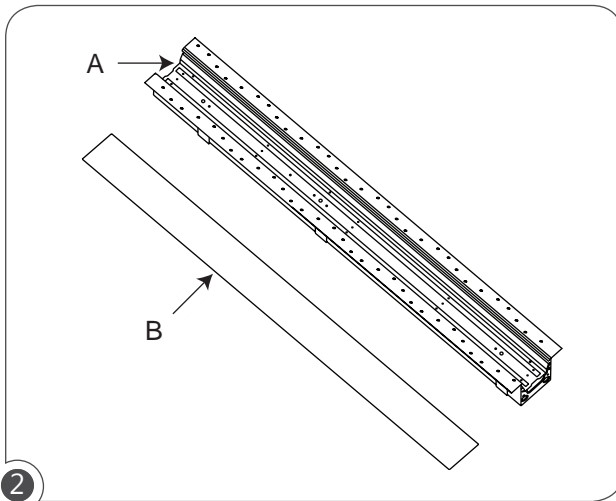

Remove Lens(B) and LED module plate(A).

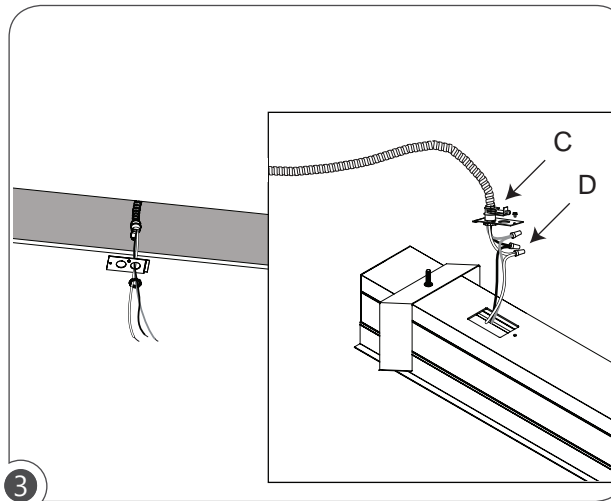

Install BX cable connector(C) to access plate(D). Wire BX cable wires to Fixture wires.

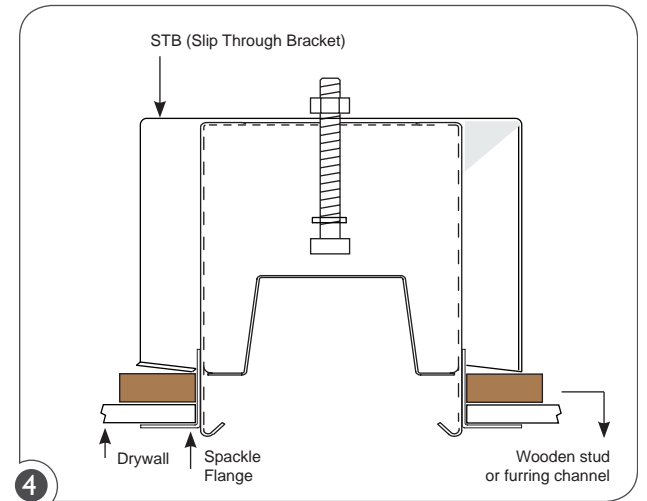

Align fixture(with slip through bracket) to pre-cut hole on drywall and insert fixture. use short wooden stud for STB.



CUBE2, CUBE4 RECESSED SPACKLE FLANGE INSTALLATION INSTRUCTIONS

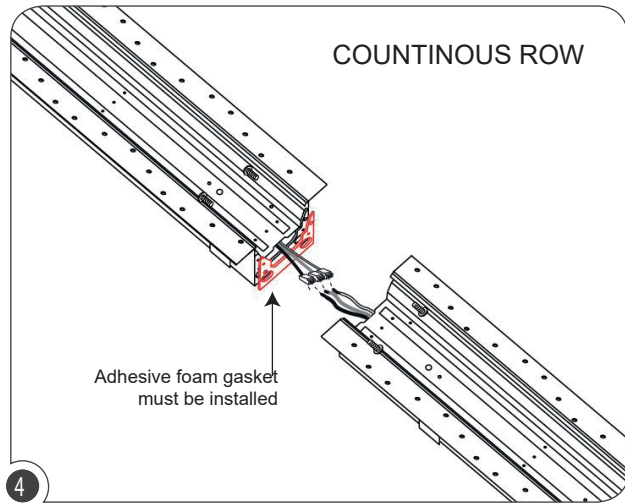

4 Refer to [4A] on the last page for detailed installation instructions.

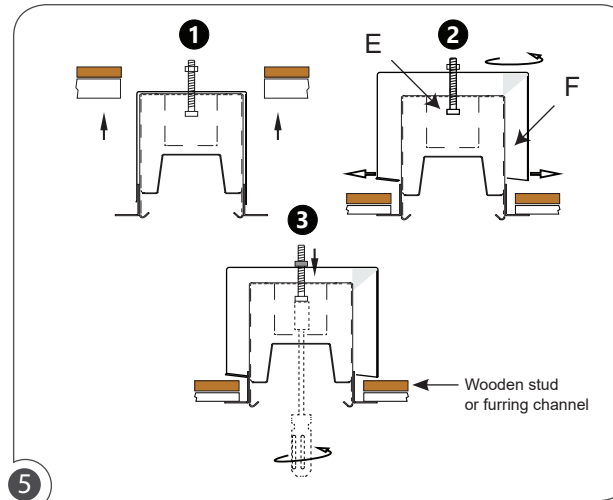

5 Push safety bracket screw(E) up to rotate safety brackets(F) once bracket is correctly align tighten screw to lock fixture in to drywall ceiling.

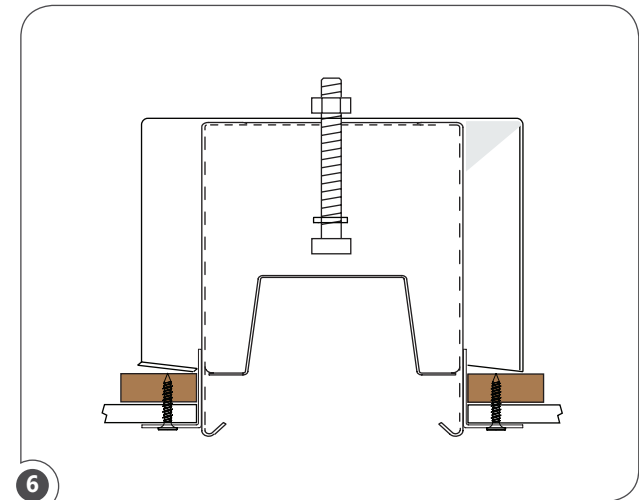

6 Wooden stud or furring channel must be used to reinforce the screws to the drywall.

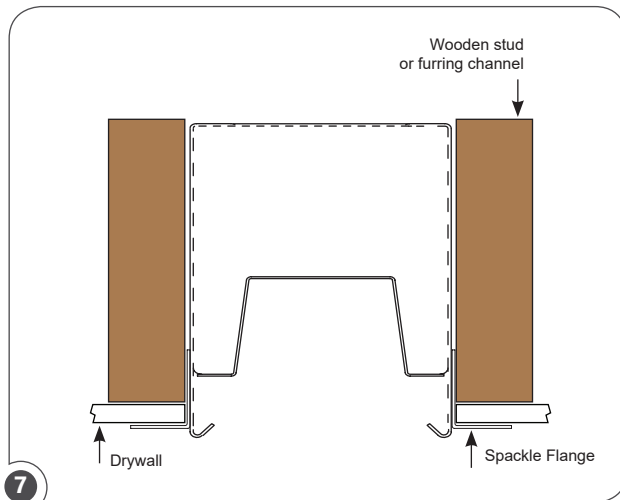

7 Align fixture(without slip through bracket) to pre-cut hole on drywall and insert fixture. use long wooden stud. (Skip this if you did 4)

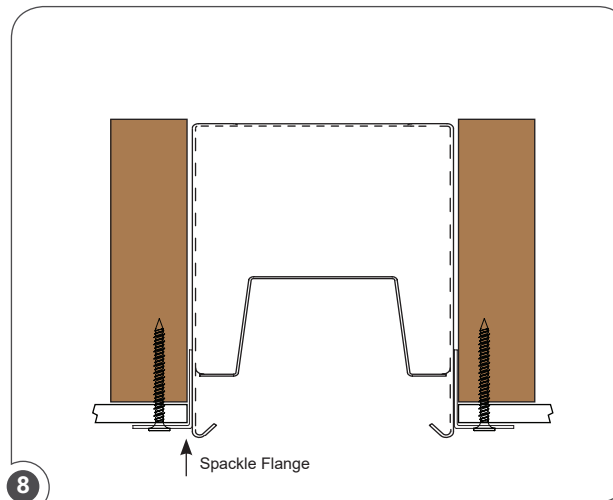

8 Wooden stud or furring channel must be used to reinforce the screws to the drywall.



CUBE2, CUBE4 RECESSED SPACKLE FLANGE INSTALLATION INSTRUCTIONS

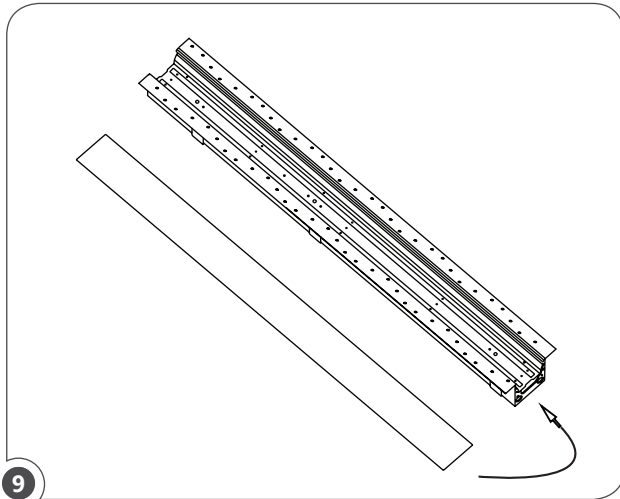

9

Reinstall LED module plate and lens.

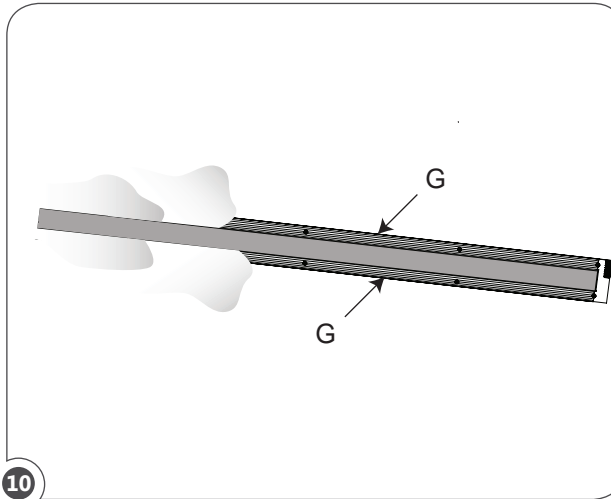

10

Unless a row installation is needed, plaster and sand over spackle flange (G) to create a smooth finish.

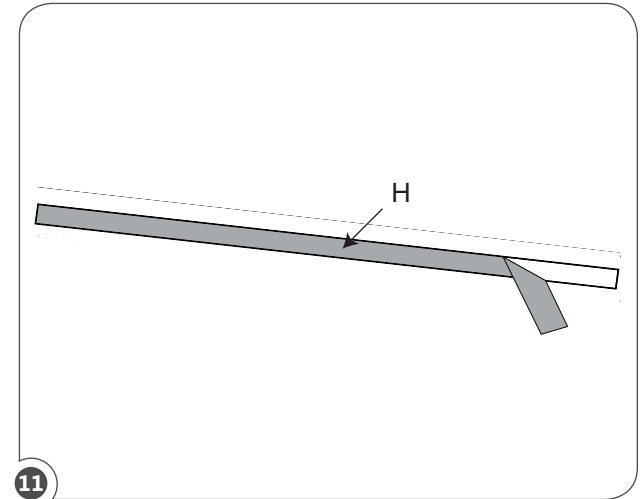

11

Remove blue tape from lens (H) BEFORE last plaster layer is fully dry.

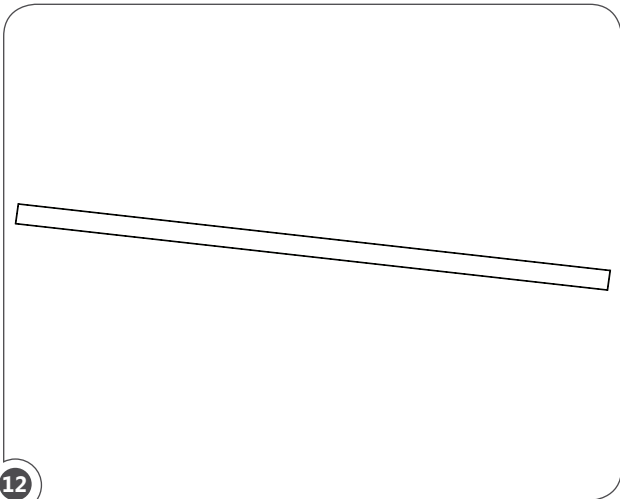

12

It is now safe to turn the fixture's circuit on.



CUBE2, CUBE4 RECESSED SPACKLE FLANGE INSTALLATION INSTRUCTIONS

CONTINUOUS ROW

TOOL(S) NEEDED:

Option 1) Cordless drill and an elbow or L-shape adapter with Philips Insert Bit extension.

Option 2) Flexible Screwdriver with Philips Insert Bit.

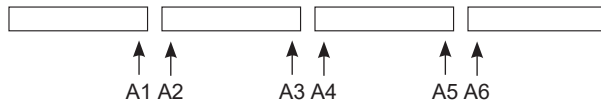

Continuous Row

Align continuous row fixtures in numerical order under the same alphabet family.

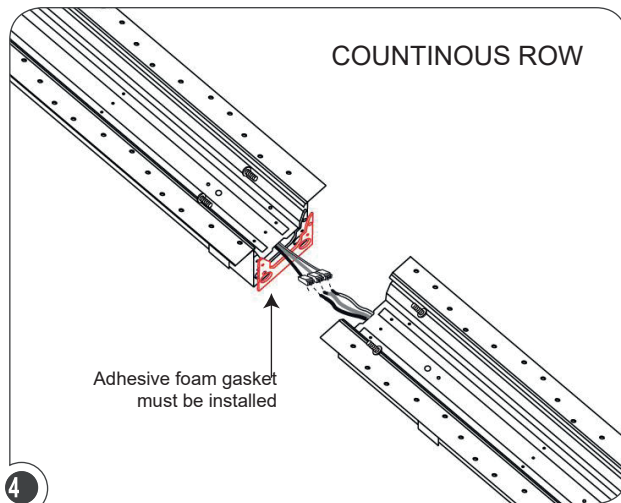

- 1) Make wiring connection from each fixture power supply wires together.
- 2) Align fixtures and screw together with 4 screws(H).



866-471-7711
utopialighting.com
info@utopialighting.com

Contractor is responsible for adequately reinforcing ceilings to support luminaire weight. Utopia Lighting accepts no responsibility for inadequately reinforced ceilings. The information contained in this drawing is the sole property of Utopia Lighting. Any reproduction in part or whole is prohibited and warranty voided.

WARNING:



RISK OF FIRE AND ELECTRICAL SHOCK. FIXTURE MUST BE INSTALLED BY A QUALIFIED ELECTRICIAN ONLY IN ACCORDANCE WITH NATIONAL, LOCAL BUILDING AND ELECTRICAL CODES. DISCONNECT POWER AT ELECTRICAL PANEL BEFORE SERVICING.